

- ✚ The FIRETREN<sup>®</sup> system is an indirect solution combining detection and extinguishing.
- ✚ It can be used to protect all types of engine compartments (buses, off-road vehicles, agricultural vehicles, etc.), as well as machine tools, generators, etc.
- ✚ The system complies with regulation 107 (Unece, e5), which is essential for equipping bus engine compartments.
- ✚ The system is the smallest in the world: with only 4 litres of extinguishing agent, it can protect an engine compartment of 4m<sup>3</sup>
- ✚ Extremely reliable, robust and compact, it fits easily into all types of applications.

## ✚ KITS

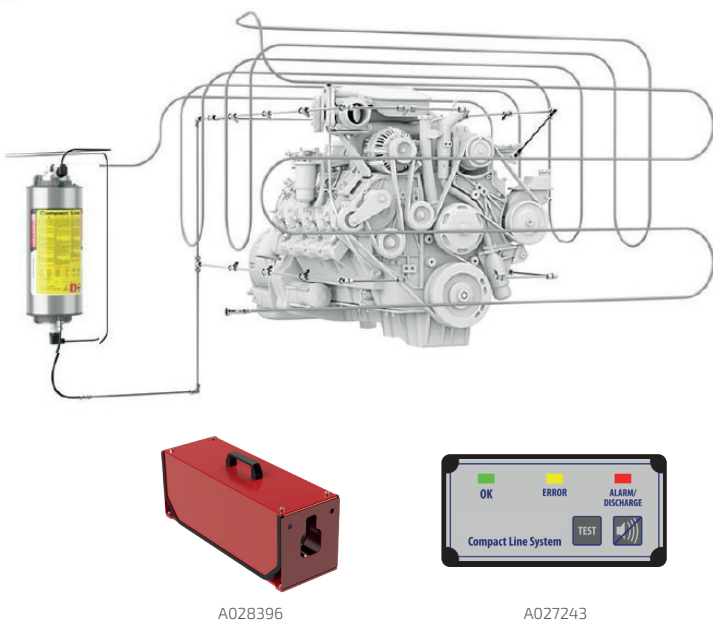

DESIGNATION	ITEM N°
<b>Détection</b>	
FIRETREN CPL 4L Kit	A027239
FIRETREN CPL 7L Kit	A027240
FIRETREN CPL 12L Kit (kit to be defined according to application)	Consult us
Driver information feedback device	A027243
<b>Protective housings / fixing</b>	
Protection Housing Firetrex CPL 4 Liters	A028397
Protection Housing Firetrex CPL 7 Liters	A028396
Protection Housing Firetrex CPL 12 Liters	A028398

## ✚ PRINCIPLE OF OPERATION

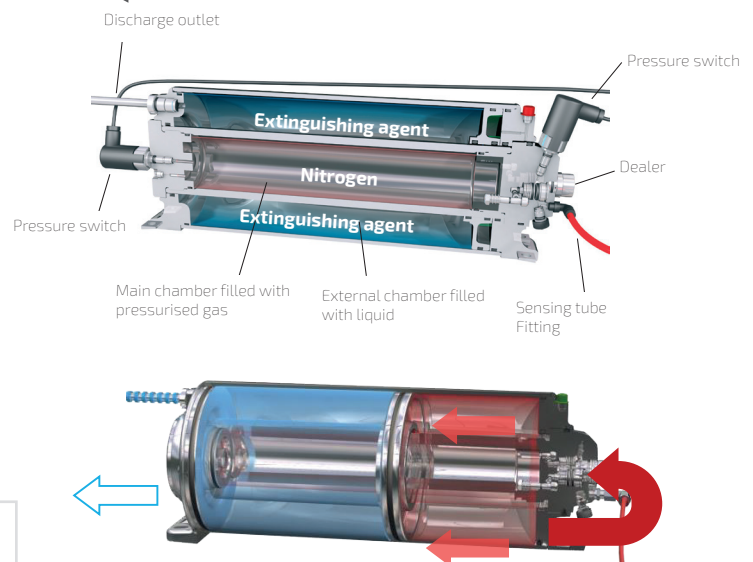

- For safety reasons, the extinguishing liquid and pressurised gas are kept in separate chambers.
- When activated, pressurised gas is released into the external chamber pressing against a piston.
- The piston pushes the liquid towards the discharge tube.
- An integrated pressure reducer guarantees a constant and long-lasting discharge (e.g. 7L with 7 nozzles: operating time approx. 1 minute).

## CRITICAL INFORMATION

- ✚ The tank must be out of the engine compartment or protected area,
- ✚ The extinguishing zone must be confined,
- ✚ It is imperative that personnel be trained for the installation and maintenance of the installations,
- ✚ 200 bar pressure tank,
- ✚ The Firetrex CPL system passes shock and vibration tests according to EN 61373 Cat1/ Class B.



The FIRETREN CPL Suppression System for forest and construction vehicles has earned FA 127:16 certification. Finland Finance (FA) FA 127:16 is one of the most recognized certifications for any off-road vehicle protection system.



In 2016, UNECE added in its Regulation 107 a procedure to certify fire protection systems as bus components. The implementation of such components in buses will be mandatory from 2018 for signatory countries.



International certification for AFSS in engine compartments of SPCR 183 buses

↘ SPARE PARTS

↘ Available in electric piloting, please consult us.

↘ OFF ROAD VEHICLES: The Firetrench CPL system passes the FA 127 certification tests. With only 4L of extinguishing agent, it protects an engine compartment of 2.25 m<sup>3</sup>, i.e. 0.56L per protected m<sup>3</sup>. For the number of nozzles, refer to the table below (UNECE R107).

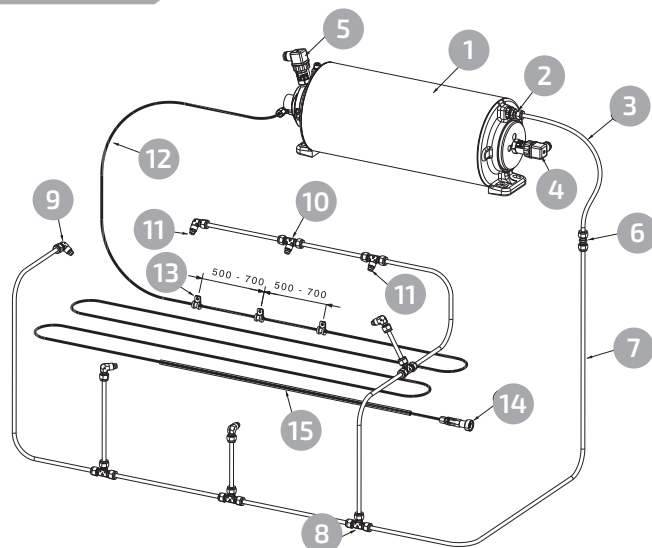

N°	DESIGNATION	ITEM N°	DESIGNATION	ITEM N°
1	Special IHP tank/valve assembly (unfilled)	See previous page	Male pressure nipple G 1/4"	Consult us
2	Double ring fitting	Consult us	Rupture disc 14 bar	Consult us
3	Rubber hose	Consult us	Connection for rupture disc	Consult us
4	Pressure switch (160 bar)	Consult us	End-of-line support bracket	Consult us
5	Pressure switch (5 bar)	Consult us	Output adapter	Consult us
6	Double ring fitting - straight	Consult us	Gasket for outlet adapter	Consult us
7	Copper pipe 6/8 mm in 1 m	A028552	Decompression valve	Consult us
8	Brass fitting Brut Te egal D8	A028542	Conical washer CompactLine fixing	Consult us
9	Fitting Brass Fitting Elbow F1/8 D8	A028545	Flexible Teflon/Stainless Steel Smooth End Cap D8-316L L500mm	A028553
10	Fitting Brass Fitting Brut Te F1/8 D8	A028543	Flexible Teflon/stainless steel hose Smooth end D8-316L L1000mm	A028554
11	Spray nozzle	Consult us	Flexible Teflon/St.Steel Smooth End Cap D8-316L L1500mm	A028555
-	Protective cap for nozzle	Consult us	Flexible Teflon/stainless steel hose Smooth end D8-316L L2000mm	A028556
12	Black tube (10 m)	A014572	Fitting Brass Rough Elbow equal D8	A028546
13	Screw clip for fixing the tube	A002440	Brass fitting Rough Brass Elbow M1/8 D8	A028547
-	Clamp Alu+Caoutc D10/12 for stainless steel springs	A021774	Brass fitting Brut Union equal D8	A028548
14	End of line pressure gauge	Consult us	Brass fitting Brut Union F1/8 D8	A028549
15	Protective spring for detection tube	A020281	Brass fitting BrutUnion M1/8 D8	A028550
			Brass fitting Rough Brass Cross equal D8	A028551

↘ DIMENSIONING



		SPCR 183	UNECE R107
ENGINE COMPARTMENT SIZE		Extinguishing agent TS 55	
SMALL COMPARTMENT V ≤ 4m <sup>3</sup>	Min. volume of extinguishing agent (litres)	1,8 x V + 4,8	0,6 x V + 1,6
	Minimum diffuser quantity (depending on nozzles)	6-90°	2,55 x V + 6,8
		6-45°	0
	Maximum discharge pipe (Metres)	13,6	1,725 x V + 4,6
	Maximum distance to the furthest diffuser (m)	6,7	-
Maximum number of connections*	83	-	
LARGE COMPARTMENT V ≥ 4m <sup>3</sup>	Min. volume of extinguishing agent (litres)	1,2 x V + 7,2	0,4 x V + 2,4
	Quantity of diffusers (depending on the type of diffusers)	6-90°	1,7 x V + 10,2
		6-45°	0
	Maximum discharge pipe (Metres)	13,6	1,15 x V + 6,9
	Maximum distance to the furthest diffuser (m)	6,7	-
Maximum number of connections*	83	-	

↘ Minimum dimensioning of the system according to the volume of the compartments of the areas to be protected, according to the UNECE R107 standard. ALL CPL PROJECTS MUST BE SUBJECT TO A VALIDATION OF YOUR REFERENCE AUTOMATIC EXTINCTION. \* A connection is defined as the coupling between a fitting and a pipe or diffuser. A T-connector, for example, has 3 connections, a straight connector has 2 connections..